

s.r.l. GORLA  
MORSETTERIE  
MILANO

TECHNICAL OFFICE

PARALLEL GROOVE CLAMP  
WITH 2 BOLTS  
FOR CU CONDUCTOR

DRG. N. 08/LR/X

SCALE

DRAWN

DATE

APPROVED

DATE

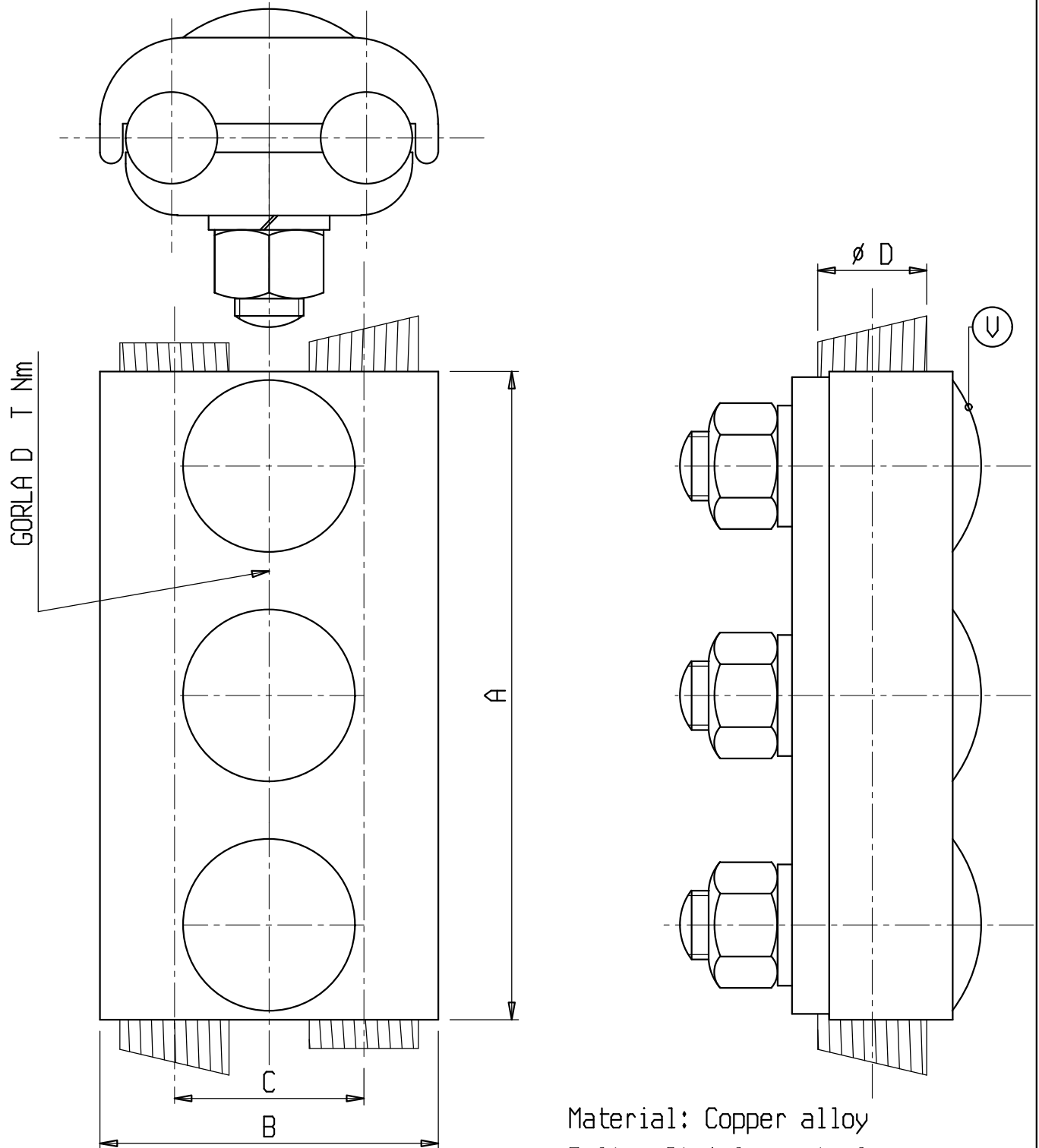

Material: Copper alloy  
Bolts: Stainless steel

X	∅ COND.	A	B	C	T	U	X	∅ COND.	A	B	C	T	U
	D							D					
LR 3668	5 - 6	60	29	16	10	M6	LR 3676	16 - 19	106	66	34	40	M12
LR 3666	7 - 9	64	38	19	20	M8	LR 3678	22 - 24	140	76	39	40	M12
LR 3317	10 - 11,5	72	48	25	30	M10							
LR 3672	11,5 - 16	99	59	33	40	M12							